



FD8133V/8134V Fixed Dome Network Camera

Quick Installation Guide

English | 繁體中文 | 简体中文 | 日本語 | Français | Español | Deutsch | Português | Italiano | Türkçe | Polski | Русский | Český | Svenska | العربية

FD8133V: 3-axis • ePTZ

FD8134V: IR Illuminators

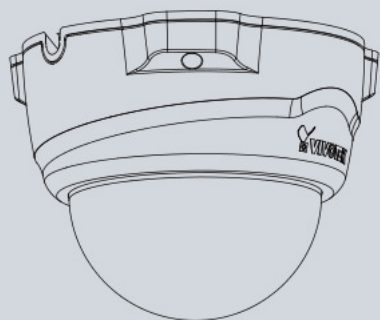

**Warning Before Installation**

- **Power off the Network Camera as soon as smoke or unusual odors are detected.**
- **Keep the Network Camera away from water. If the Network Camera becomes wet, power off immediately.**



Contact your distributor in the event of occurrence.



Contact your distributor in the event of occurrence.

- **Do not place the Network Camera around heat sources, such as a television or oven.**
- **Refer to your user's manual for the operating temperature.**

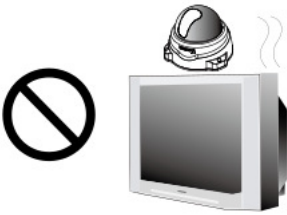

- **Keep the Network Camera away from direct sunlight.**
- **Do not place the Network Camera in high humidity environments.**



● Do not place the Network Camera on unsteady surfaces.



● Do not touch the Network Camera during a lightning storm.



● Do not disassemble the Network Camera.

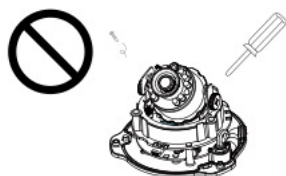

● Do not drop the Network Camera.



● Do not insert sharp or tiny objects into the Network Camera.



● Replacing or failing to properly install the waterproof components, e.g., cables or cable glands, will void our IP65/66/67 warranty.



1 Package Contents

● FD8133V or FD8134V

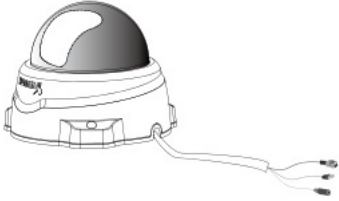

● Power Adapter



● Software CD



● Alignment Sticker



● Quick Installation Guide / Warranty Card



● RJ45 Female/Female Coupler / Screwdriver/ Screws / Clamp Core



2 Physical Description

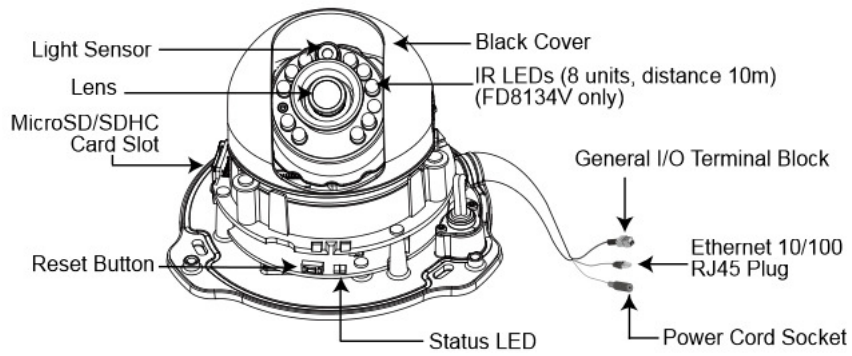

3 Hardware Installation

First, follow the instructions below to remove the dome cover.

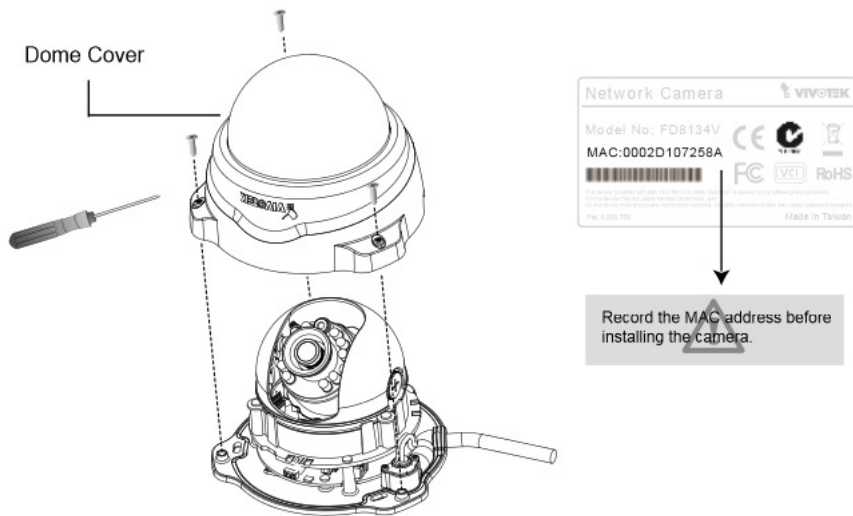

Then remove the black cover as shown below.

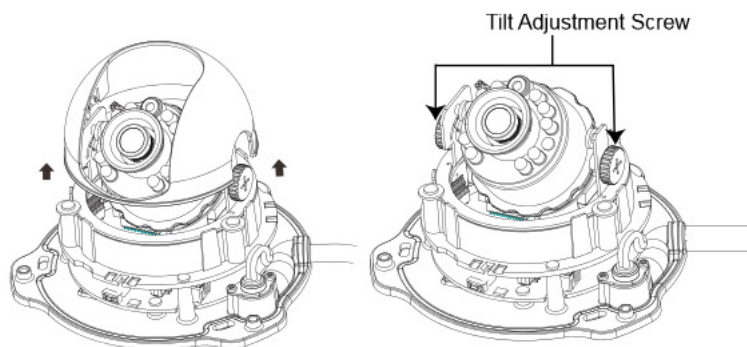

With idiot-proof mechanism design and very compact size, this Network Camera is very easy for user to install in diverse indoor environment.

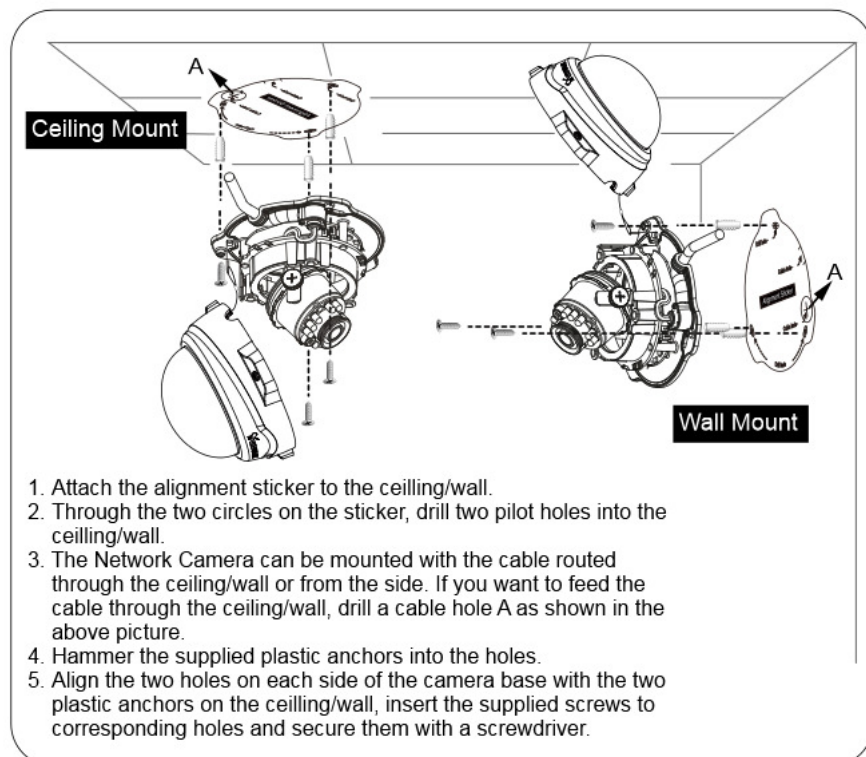

6. Buckle the supplied clamp core onto the cable to against the EMI radiation.

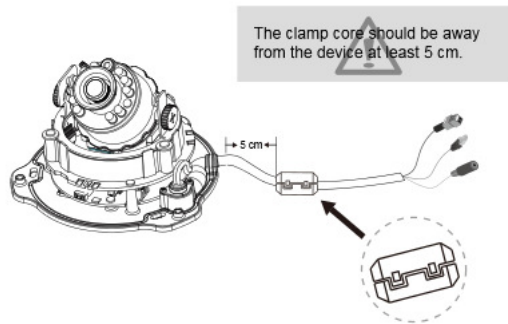

4 Network Deployment

General Connection (without PoE)

1. If you have external DI devices, make the connection from general I/O terminal block.
2. Use the supplied RJ45 female/female coupler to connect the Network Camera to a switch.
Use a Category 5 Cross Cable when Network Camera is directly connected to PC.
3. Connect the supplied power cable from the Network Camera to a power outlet.

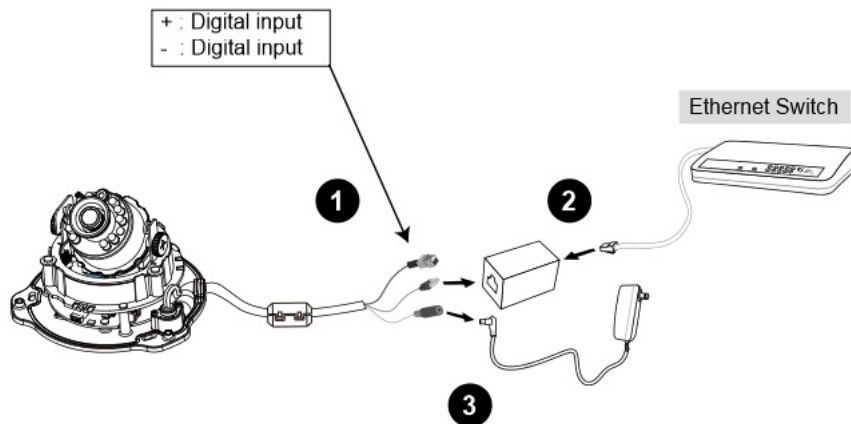

● When using a PoE-enabled switch

This Network Camera is PoE-compliant, allowing transmission of power and data via a single Ethernet cable. Follow the below illustration to connect the Network Camera to a PoE-enabled switch via Ethernet cable.

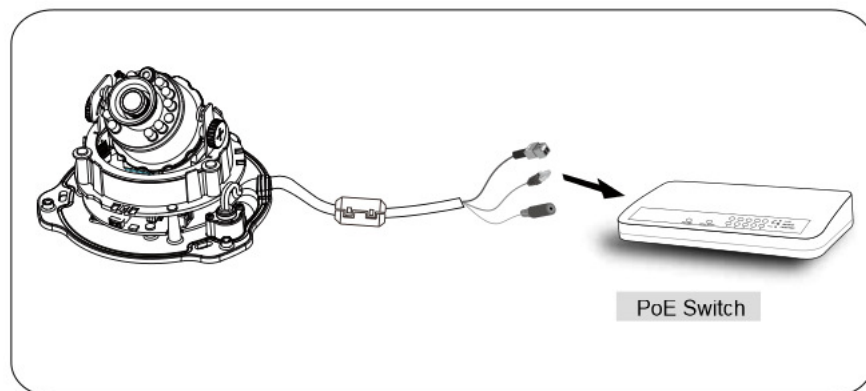

● When using a non-PoE switch

Use a PoE power injector (optional) to connect between the Network Camera and a non-PoE switch.

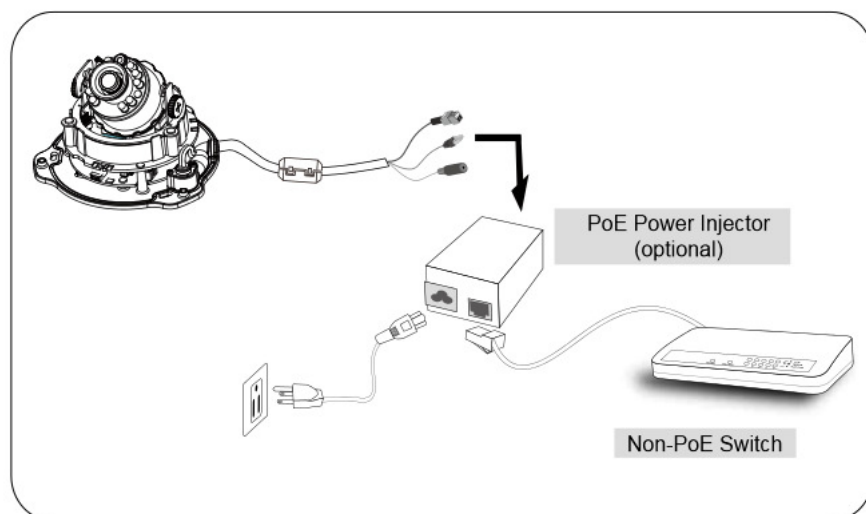



IMPORTANT!

Although the camera and the cable gland on the camera's end are waterproof, the cable molding at the other end is not waterproof.

Measures should be taken to prevent water from leaking in through the cable-end molding, such as the use of expanding foam sealant, putties, and so on. Note that the cable gland on the camera should also be securely fastened to attain its waterproof functionality.

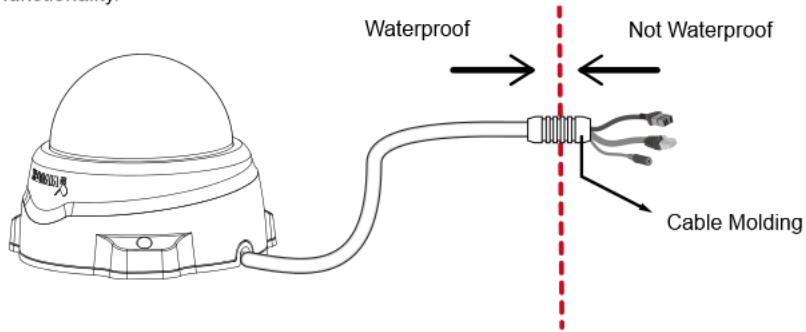

5 Assigning an IP Address

1. Install "Installation Wizard 2" from the Software Utility directory on the software CD.
2. The program will conduct an analysis of your network environment. After your network is analyzed, please click on the "Next" button to continue the program.

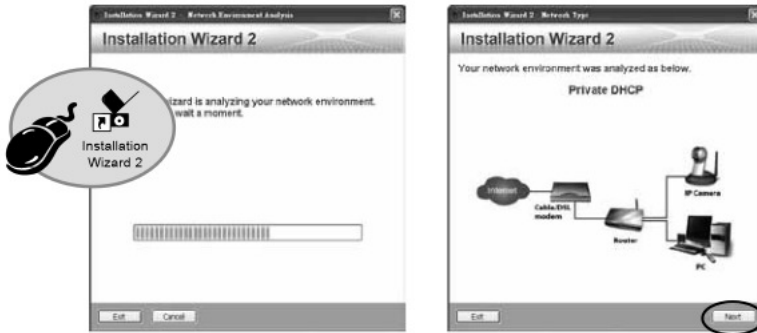

3. The program will search for VIVOTEK Video Receivers, Video Servers, and Network Cameras on the same LAN.
4. After searching, the main installer window will pop up. Click on the MAC that matches the one labeled on the bottom of your device to connect to the Network Camera via Internet Explorer.



1. Access the Network Camera on the LAN.
2. Retrieve live video through a web browser or recording software.



For further setup, please refer to the user's manual on the software CD.

7 Adjusting the Lens

Based on the live image retrieved from the camera, adjust the camera lens to the desired viewing angle:

1. Turn the lens module left and right.
2. Loosen the tilt adjustment screws on both sides of the camera and then turn the lens module up and down. Upon completion, tighten the screws.
3. Turn the lens to adjust the image orientation.

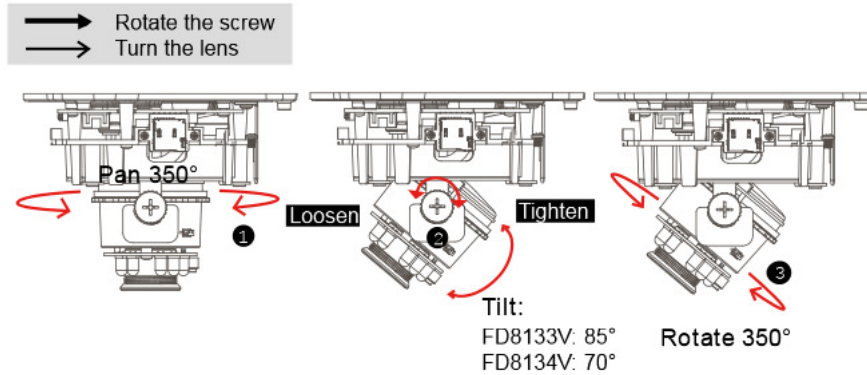

3-axis Mechanism Design

The sophisticated 3-axis mechanism design offers very flexible, easy hardware installation for either ceiling or wall mount.

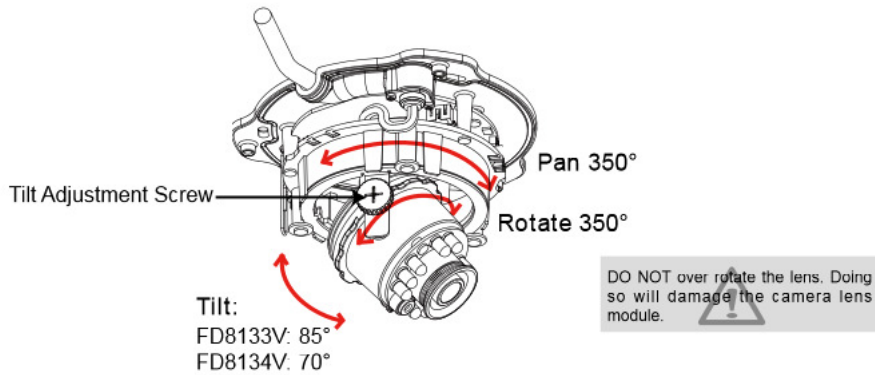

8 Completion

1. Align the inner side of the black cover with the notch on both sides of the lens, x the black cover.
2. If you choose to feed the cable through the ceiling/wall, arrange the cable neatly through the cable hole. If you choose to feed the cable from the side, remove plate B.
3. Attach the dome cover to the camera as the direction shown below. With idiot-proof mechanism design, the dome cover cannot be attached if the angle does not t.
4. Finally, make sure all parts of the camera are securely installed.

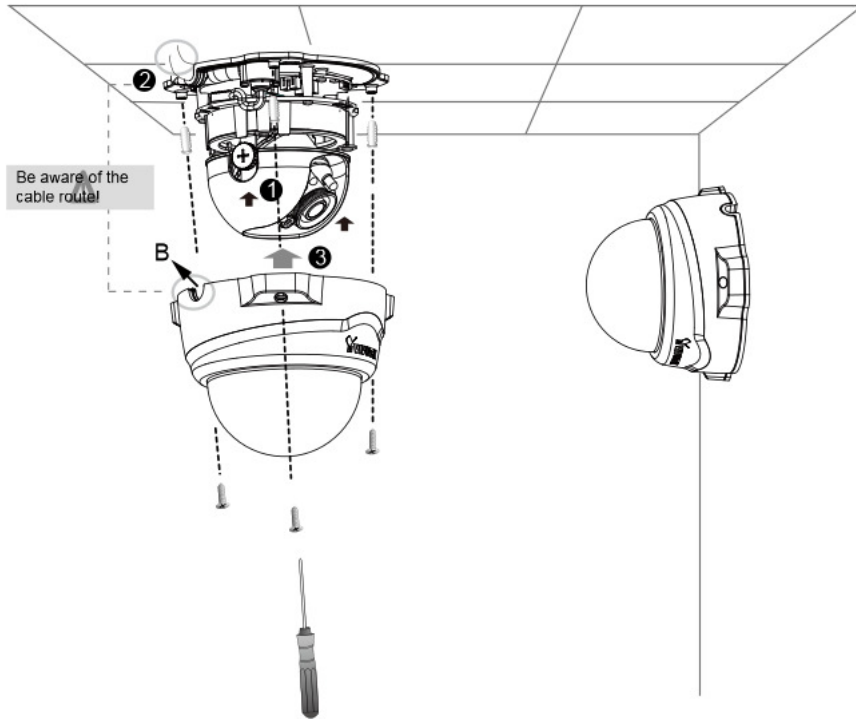

Patent applications are submitted to hang without notice
Copyright © 2015 Vivotek, Inc. All rights reserved.



VIVOTEK INC.
8F, No.192, Lien-Cheng Rd., Chung-Ho, New Taipei City, 235, Taiwan, R.O.C.
| T +886-2-82455282 | F +886-2-82455532 | E sales@vivotek.com

VIVOTEK USA, INC.
2050 Ringwood Avenue, San Jose, CA 95131
| T 408-773-8686 | F 408-773-8298 | E salesusa@vivotek.com