



FD8335H Fixed Dome
Network Camera

Quick Installation Guide

English | 繁體中文 | 简体中文 | 日本語 | Français | Español | Deutsch | Português | Italiano | Türkçe | Polski | Русский | Česky | Svenska | العربية

720P HD • P-Iris • WDR Pro
IP66 Vandal-proof

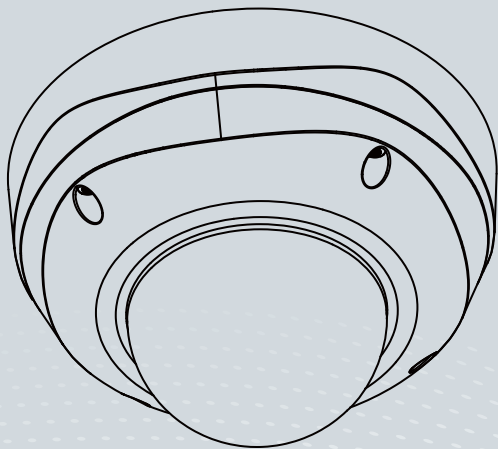



Warning Before Installation

- **Power off the Network Camera as soon as smoke or unusual odors are detected.**



Contact your distributor in the event of occurrence.

- **Refer to your user's manual for the operating temperature.**

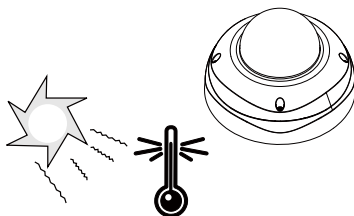

- **Do not place the Network Camera on unsteady surfaces.**

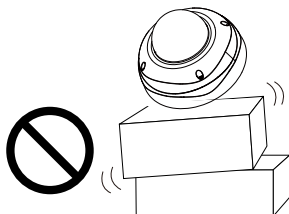

- **Do not touch the Network Camera during a lightning storm.**

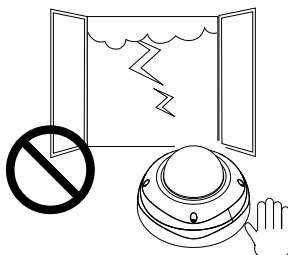

- **Do not insert sharp or tiny objects into the Network Camera.**

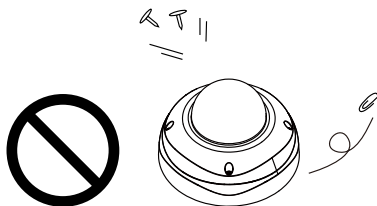

- **Do not drop the Network Camera.**

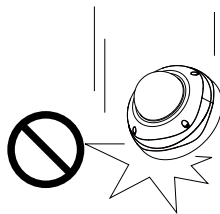

1

Package Contents

FD8335H

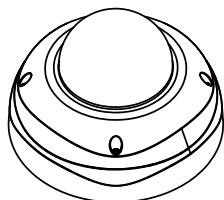

Alignment Sticker / Ceiling Hole Template Sticker

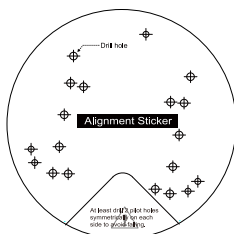

Quick Installation Guide / Warranty Card



Waterproof Connector & Bushing

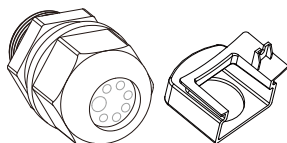

Mounting Plate

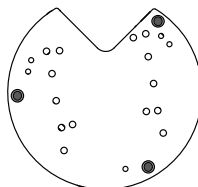

L-type Hex Key Wrench / Moisture Absorber / Screws / Hex Nut / Double-sided Tape / AV Cable

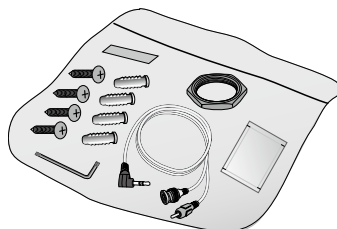

Software CD



2 Physical Description

Inner View

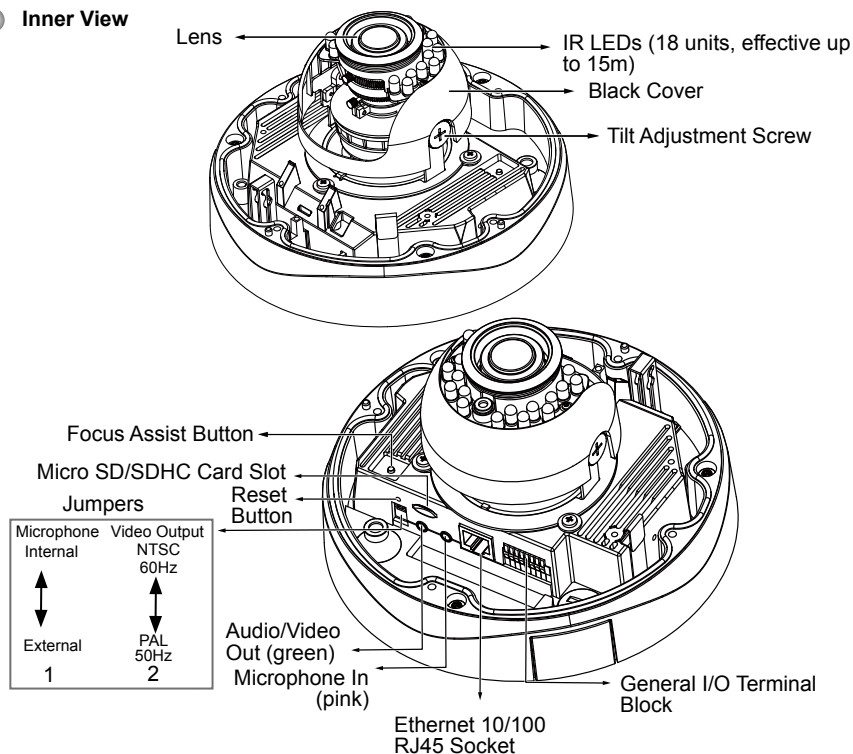

1. There is no internal microphone. Only external microphone is applicable.
2. The Focus Assist button takes effect when using a hand-held monitor or camera tester with a BNC connector. Press the button and use the focus and zoom adjustment pullers to tune the image until the "BEST FOCUS" message is shown.



LCD Monitor/
Camera tester

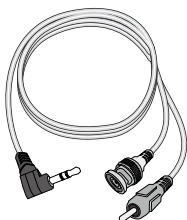

Focus Assist
Button

AV Out

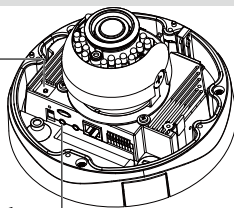



Record the MAC address under the camera base before installing the camera.

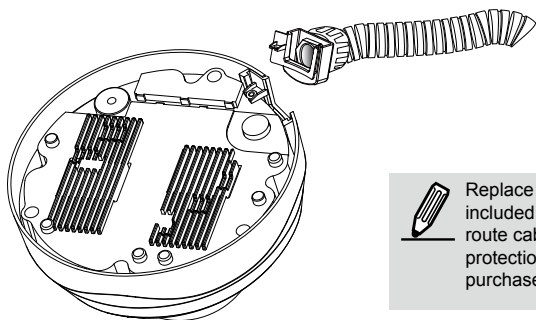
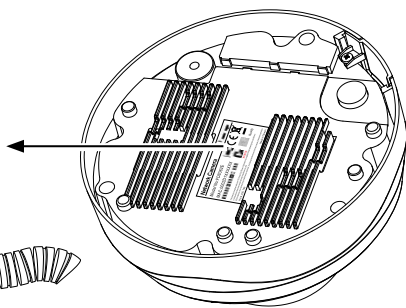

Replace the side opening cover with the included side outlet bushing if you want to route cables from the side of camera. The 1/2" protection conduits and tubing are separately purchased.

3

Hardware Installation

First, use the included T20 hex key wrench to loose the four screws and detach the dome cover from the camera base. Follow the steps below to install the camera either to a ceiling or a wall.



IMPORTANT! Dome cover should be removed because if it should fall during the installation process, physical injury could occur to your co-workers.

Top View

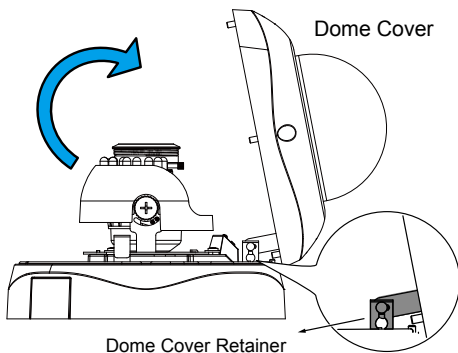
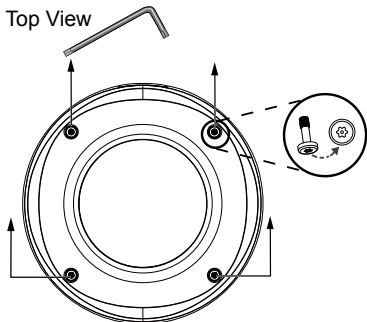

Cabling Assembly

Connect power lines and if you have external devices such as sensors and alarms, make the connection from the general I/O terminal block.

Pin Definitions

1	AC24V_2
2	AC24V_1
3	DI3+
4	DI2+
5	DI1+
6	DI-
7	DO-
8	DO+ (12V)

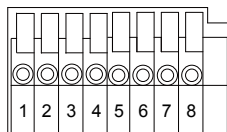

Power and IO cables pass through a waterproof connector. The Ethernet cable should be routed through a rubber seal plug. All cables are user-supplied.

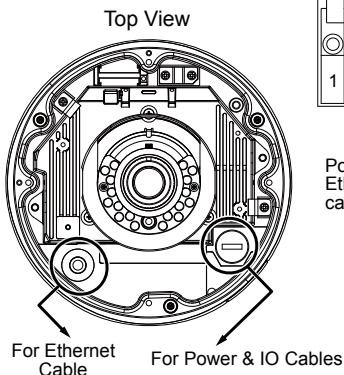

Waterproof Connector

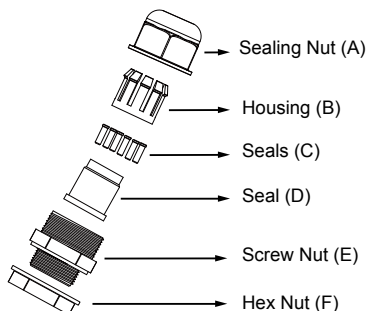

Assembling Steps

1. Disassemble the components of the waterproof connector into parts (A) ~ (F) as shown above.
2. Place the screw nut (E) on the Power and GPIO opening.
3. Feed the power cables through the waterproof connector (F --> E --> D --> B --> A) as the illustration shows. Then connect the power cables to the power source. Note: There are 8 holes on the seal (D), and the widest holes with a crack on the side are specific for power cables.
4. If you have external devices such as sensors and alarms, feed the cables through the

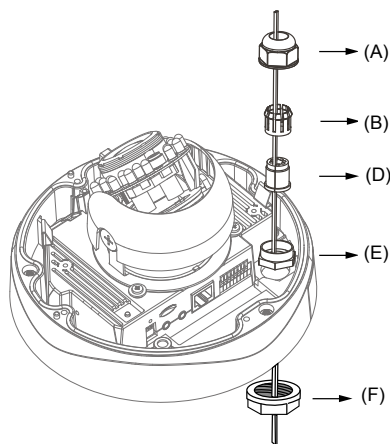

waterproof connector (F --> E --> D --> B --> A) as previously described. Refer to the pin definition to connect them to the general I/O terminal block. Note: The recommended cable gauge is 2.0 ~ 2.8 mm.

5. Push the seal (D) into the housing (B).
6. Insert the seals (C) into unused holes on the seal (D) to avoid moisture.
7. Secure the sealing nut (A) tightly and hex nut (F) from the bottom of the camera.

Connecting RJ45 Ethernet Cable

● RJ45 Cable Dimension (unit: mm)

Recommended cable gauge: 24AWG (0.51 mm)

● Assembling Steps

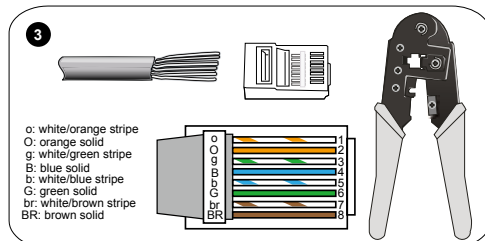
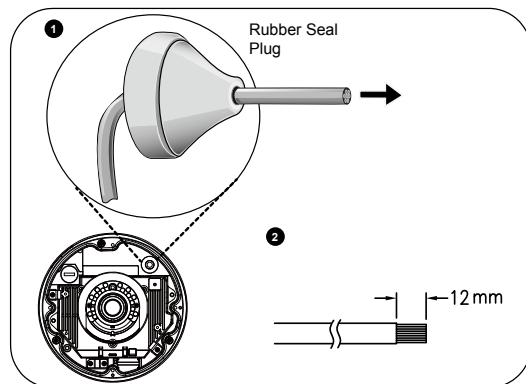

4. Press the Ethernet cable into the routing path at the bottom of the camera so that the cable will not get in the way when the metal mounting plate is attached.

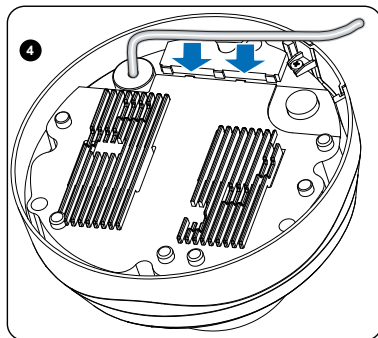

Wall mount

1. Attach the supplied alignment sticker to the wall.
2. Using the circle marks on the sticker, drill at least 2 pilot holes symmetrically on each side into the wall. Then hammer the four supplied plastic anchors into the holes.
3. Through three or four holes on the mounting plate, insert the supplied screws into the corresponding holes and secure the mounting plate with a screwdriver.
4. Feed the cables through the triangular cutout A or side opening B. If you want to use hole B, remove the side cover using a screwdriver. Secure the camera base to the mounting plate with three supplied screws.
5. Remove the black cover.

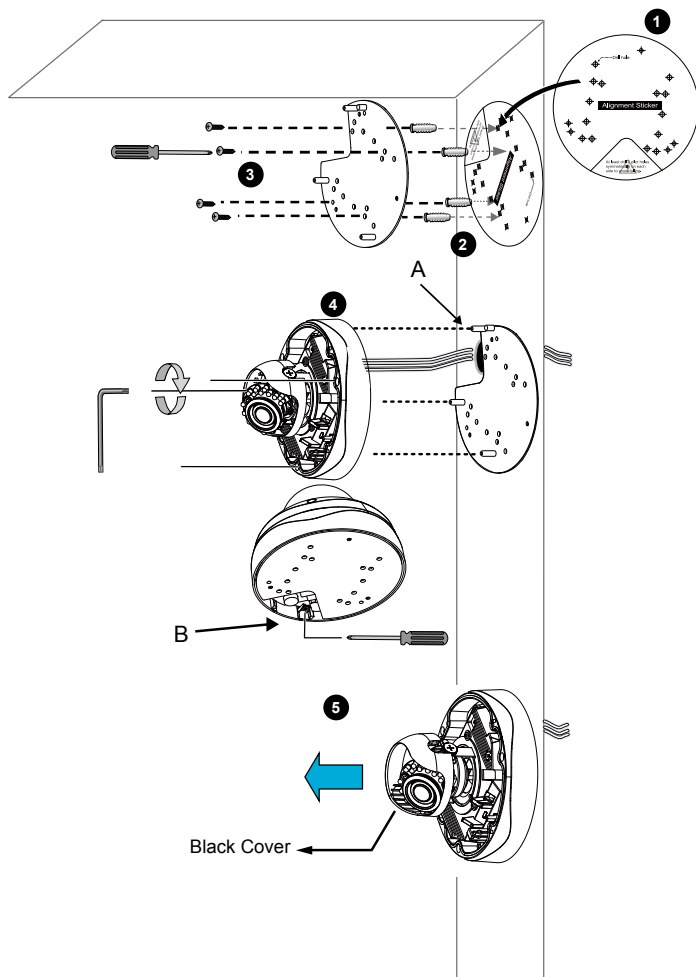

Ceiling mount

1. Attach the supplied alignment sticker to the ceiling.
2. Using the circle marks on the sticker, drill at least 2 pilot holes symmetrically on each side into the ceiling. Then hammer the four supplied plastic anchors into the holes.
3. Through three or four holes on the mounting plate, insert the supplied screws into the corresponding holes and secure the mounting plate with a screwdriver.
4. Feed the cables through the triangular cutout A or side opening B. If you want to use hole B, remove the side cover using a screwdriver. Secure the camera base to the mounting plate with three supplied screws.
5. Remove the black cover.

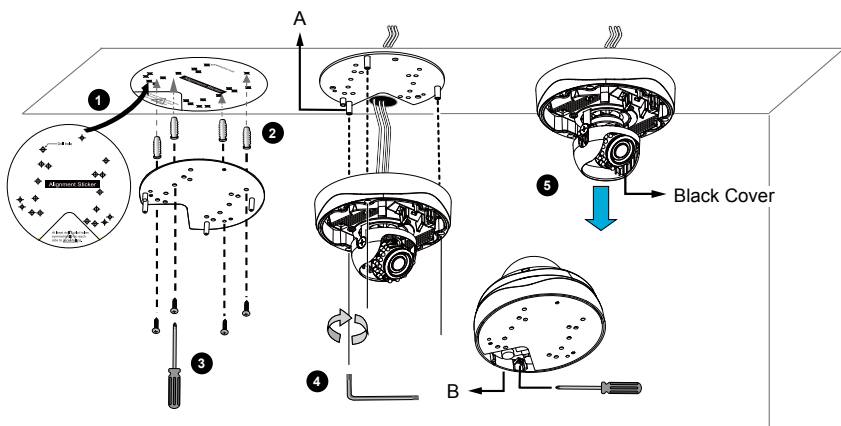

4

Network Deployment

General Connection (without PoE)

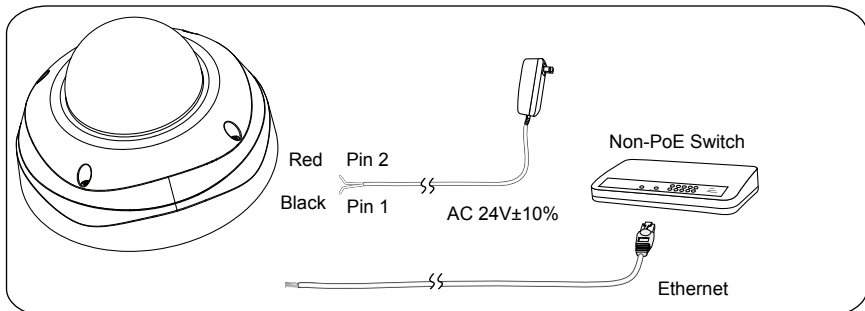

1. Connect RJ45 Ethernet cable to a switch. Use a Category 5 Cross Cable when your network camera is directly connected to PC.
2. Connect the AC cables from the terminal block as an alternate power source. The IO cables are user-supplied.

Power over Ethernet (PoE)

When using a PoE-enabled switch

The Network Camera is PoE-compliant, allowing transmission of power and data via a single Ethernet cable. Follow the below illustration to connect the Network Camera to a PoE-enabled switch via Ethernet cable.

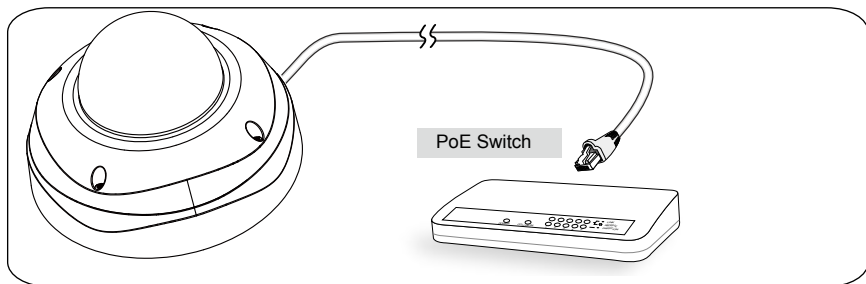

When using a non-PoE switch

Use a PoE power injector (optional) to connect between the Network Camera and a non-PoE switch.

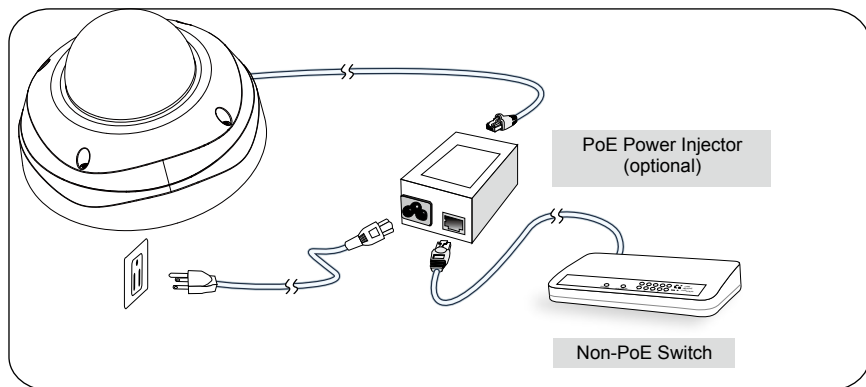

5 Assigning an IP Address

1. Install "Installation Wizard 2" from the Software Utility directory on the software CD.
2. The program will conduct an analysis of your network environment. After your network is analyzed, please click on the "Next" button to continue the program.

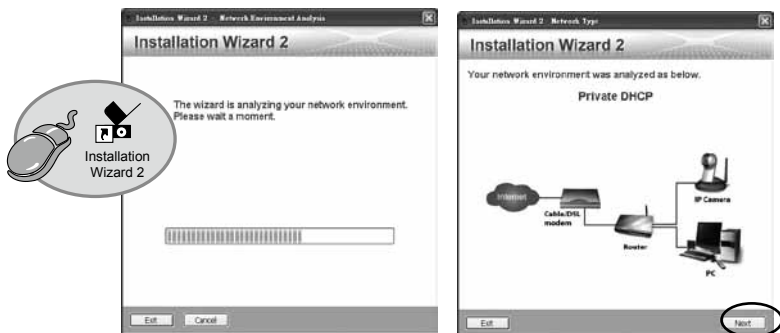

3. The program will search for VIVOTEK Video Receivers, Video Servers, and Network Cameras on the same LAN.
4. After a brief search, the main installer window will pop up. Double-click on the MAC address that matches the one printed on the camera label or the S/N number on the package box label to open a browser management session with the Network Camera.



6 Ready to Use

1. A browser session with the Network Camera should prompt as shown below.
2. You should be able to see live video from your camera. You may also install the 32-channel recording software from the software CD in a deployment consisting of multiple cameras. For its installation details, please refer to its related documents.



For further setup, please refer to the user's manual on the software CD.

7 Adjusting the Lens

Based on the live image retrieved from the camera, adjust the camera lens by doing the following:

To adjust the viewing angle -- 3-axis mechanism design

1. Loosen the tilt adjustment screws and then turn the lens module up or down, tighten the screw.
2. Turn the lens to adjust the image orientation.

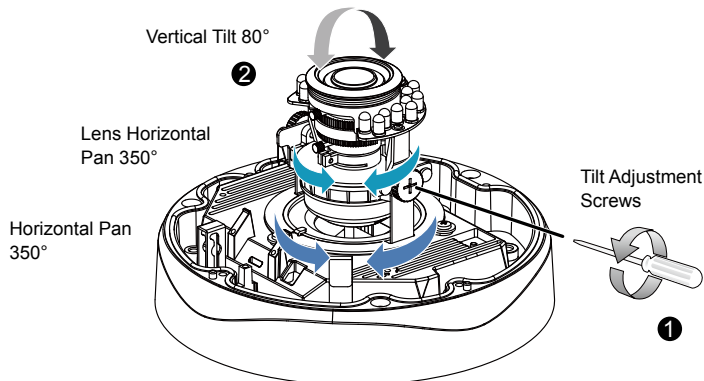

To adjust the zoom factor and focus range

1. Loosen the zoom controller and then adjust zoom factor by moving the controller left and right. Upon completion, tighten the zoom controller screw.
2. Loosen the focus controller and then adjust focus range by moving the controller left and right. Upon completion, tighten the focus controller screw.

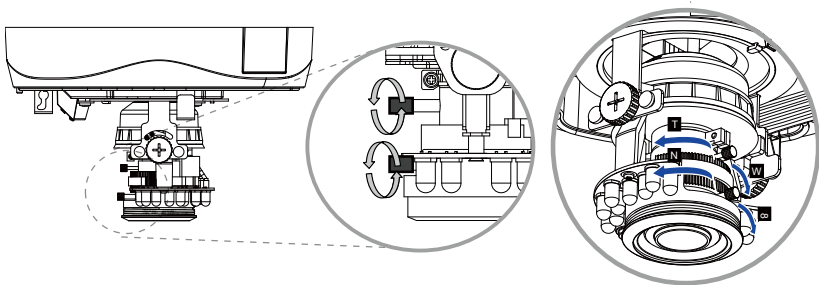

8 Completion

1. Install the black cover.
2. Attach the dome cover to the camera by combining it to the retainer and aligning with the mounting holes.
3. Secure the four dome screws with the supplied hex key wrench. Make sure all parts of the camera are securely installed.

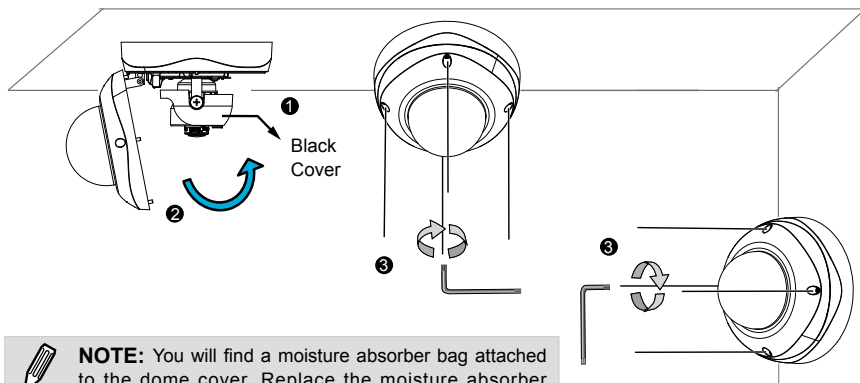

NOTE: You will find a moisture absorber bag attached to the dome cover. Replace the moisture absorber included in the camera with the one shipped within the accessory bag.

P/N:625016500G Rev. 1.0
All specifications are subject to change without notice.
Copyright © 2011 VIVOTEK INC. All rights reserved.



VIVOTEK INC.

6F, No.192, Lien-Cheng Rd., Chung-Ho, New Taipei City, 235, Taiwan, R.O.C.
| T: +886-2-82455282 | F: +886-2-82455532 | E: sales@vivotek.com

VIVOTEK USA, INC.

2050 Ringwood Avenue, San Jose, CA 95131
| T: 408-773-8686 | F: 408-773-8298 | E: salesusa@vivotek.com